

Panasonic KX-NS700 DoorPhone Setup Telquest Tech Support

4.7.1 DPH2 Card (KX-NS5162)

Function

A doorphone card for 2 doorphone, 2 door opener, and 2 external sensor.

A Doorphone Card is installed in CO Line slot.

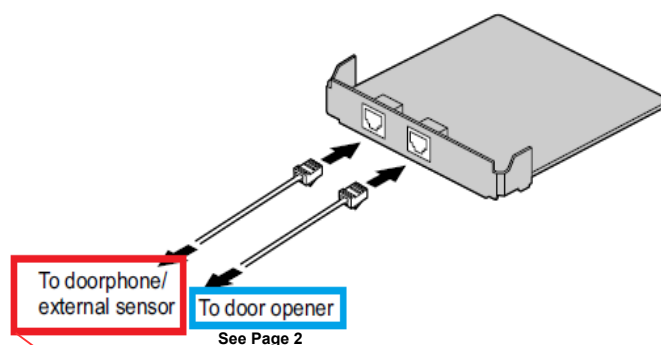

PIN Assignment

PIN Assignment for Doorphone Port

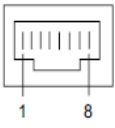
	No.	Signal Name	Function
	1	DP1	Doorphone 1 transmit
	2	COM1	Doorphone 1 receive
	3	SENS1a	Sensor 1
	4	DP2	Doorphone 2 transmit
	5	COM2	Doorphone 2 receive
	6	SENS1b	Sensor 1 common
	7	SENS2a	Sensor 2
	8	SENS2b	Sensor 2 common

The DoorPhone Card does not offer any Normally Closed Contacts

PIN Assignment for Door opener Port

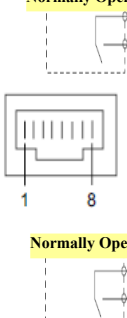
	No.	Signal Name	Function
	1	OP1a	Door opener 1 (Relay 1)
	2	OP1b	Door opener 1 com (Relay 1 com)
	3	Reserved	-
	4	Reserved	-
	5	Reserved	-
	6	Reserved	-
	7	OP2a	Door opener 2 (Relay 2)
	8	OP2b	Door opener 2 com (Relay 2 com)

Normally Open
Contacts

Normally Open
Contacts

External Sensor

Power to the external sensor is provided from the DPH2 card and must be grounded through the DPH2 card as indicated in the diagram below. A pair of "sensor" and "common" lines are connected to the DPH2 card for each external sensor. The PBX detects input from the sensor when the signal is under 100 Ω .

Connection Diagram

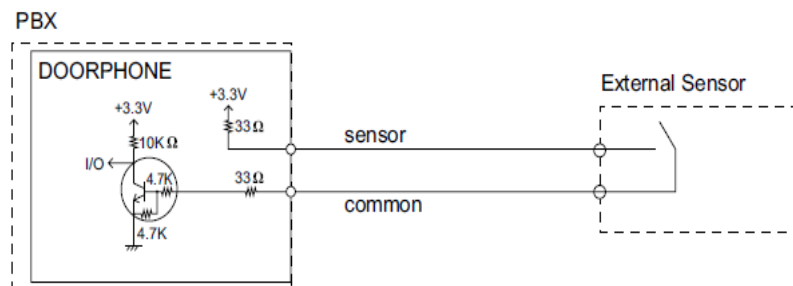

Door Opener

Current Limit: 24 V DC/30 V AC, 1 A maximum

Ring the phones when there is a DoorPhone call:

You must put the phones that will ring in their own separate Incoming Call Distribution Group.

This Help Sheet does not explain how to do that.

In this example. I am using ICDG 603

1. Click here...

2. Click here...

3. Click here...

4. Name them...

5. Enter the ICDG Number For Day/Lunch/Break/Night for each DoorPhone

DOORPHONE Number	Shelf	Slot	Port	Name (20 characters)	Destination - Day	Destination - Lunch	Destination - Break	Destination - Night	Tenna Num
1	1	4	1	Door 1	603	603	603	603	1
2	1	4	2	Door 2	603	603	603	603	1

To Operate the Door Relay:

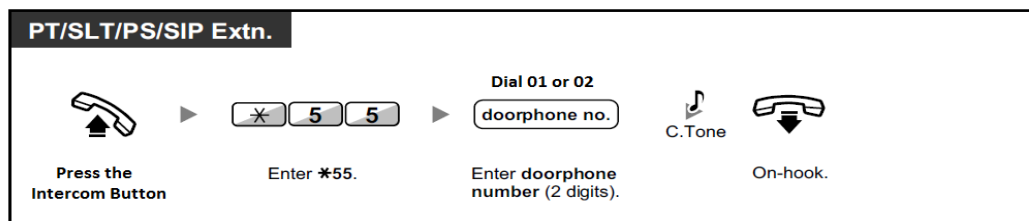

From any extension while talking to the doorphone

